

HARVARD UNIVERSITY
LABORATORY NOTEBOOK
Physics 1

NAME

SECTION

INSTRUCTOR

Harvard Coöperative Society

THIS BOOK BELONGS TO

CLASS OF _____

HARVARD COOPERATIVE SOCIETY
CAMBRIDGE, MASS.

E 10165

2003.36.1.24

1.65

2

May 11

Ascher

1 Rue des Beaux Arts Paris 6

Re Your letter apparently statue not on ^{American} Reporter also no
papers have arrived please airmail ^{to me} duplicats, ^{shipping} papers and
invoice

May 4 Monday

3

Transvaal Museum Koch or Fitzsimons I should know soon if going Somaliland stop can have Powerwayer or silybixites also Sandrover Please cable.

Cohencars Windhoek Please telegraph Silberbauer care D.E. Shauzi Dodge no longer available account our needs This informs you also. Regards Marshall

Mme Ascher
1 Rue des Beaux Arts Paris 6^e May 4 1959 N.L.
Maternity figure not yet received stop please advise when and how shipped. Stop Regards Marshall
Bryant St. Cambridge Mass

Paul Gauguin - G. D. de Montfried and Their Friends
Editions de "La Tramontaine" Perpignan 1958 by Dr René Puig

Gauguin by Robert Rey. translated by F.C. de Sumichrast
with 40 illustrations New York Dodd, Mead & Co. 1924
Masters of Modern Art Series.

Paul Gauguin Letters to his wife & Friends Edited by Malingue
translated by Henry J. Stenning
The Saturn Press - London

also
lettres de Gauguin a sa femme et a ses amis recueillies et
prefacées par Maurice Malingue et illustrées de trente deux
reproductions en heliogravure. Editions Bernard Grasset 1946
61 Rue des Saints-Pères Paris VI

2 limited editions also

Paul Gauguin's Intimate Journals Preface by Emile Gauguin 1936
translated by Van Wyck Brooks. Crown Publishers. N.Y.

Reproduced - Gauguin Peintre Maudit by Charles Kunzler Paris 1934 p. 170
Gauguin by Maurice Malingue Monaco 1944 p. 148
Gauguin by Jean Toulon Paris 1953 p. 4
"Paul Gauguin" L'Art et les Artistes Nov 1925 p. 63 by Gustave Kahn

4

Letter from J. Carmichael May 1 59 telling about
Mr. J. J. Fenykovi whose address from J. J. over the
telephone May 5 and is Plaza Maria
Goerrero #2 Madrid
Telephone 33-2695

I talked with Mrs. at Sheraton ~~Hotel~~ East Hotel
at 5:30 P.M. She was very gracious.

I should stop in to see him in Madrid. He
left slides with Gibson or Kelley at Smithsonian.

He knows P. Estermann at S'a da Bandeira who
told him our work was outstanding.

May 7,

Ordered 1 glossy each 55-109P-0 } from Sr. Clair and
55-38P-29 } Price to be sent
55-113P-5 } to E. M. T. bill to me

Sent May 17[±]

and for giving me his address in New York.

Dear Leonard: - Thank you again for your letter telling
me of Mr. Fenykovi. I talked with him on the telephone and
found that he has ^{visited} been in the ^{very} part of Angola that we wish to visit.
It also developed that I have been part his Angola home in Huayata
and have crossed his land with a man who I think is his manager.
It also happens that both he and I are devoted to a Father Estermann in
S'a da Bandeira, who has written some excellent studies of the natives
of Angola and who is ^{also} interested in Bushmen. He has invited me to visit
him in Madrid, which I shall certainly try to do on my way to Africa in June.
I will keep you advised.

I arrive Windrock about June 15. would plan ^{expedition} leave July 1
 with Stephen Thomas and Deborah Marshall John's wife Deborah stop
 Elizabeth can join us ~~about~~ between July 15 and 20 ~~wherever~~
 possibly at Elizabethville ~~other~~ book.

May 18

Says Mr. Young at Fin Arts. and keep uniform as possible.

He says get sheet of Mylar for Gaches
 Said see Prof I. Dr. Bailey

Holma K. 7-6888
 Ext. 2364

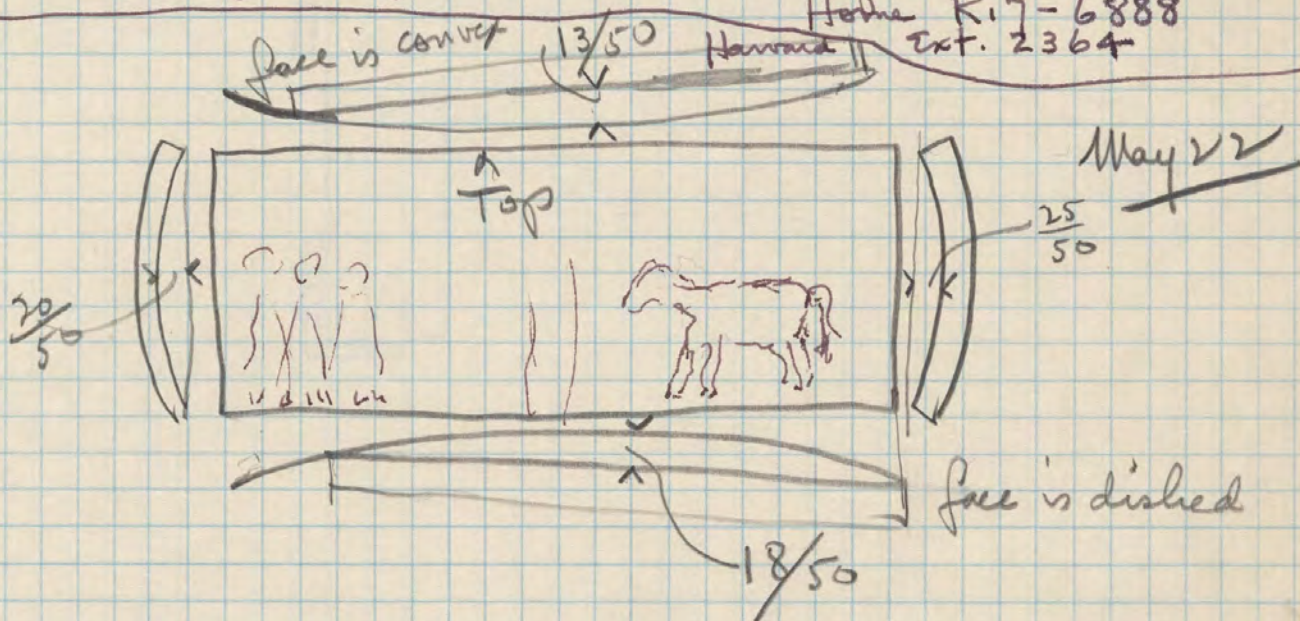

6

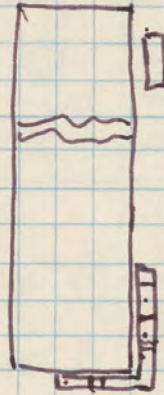
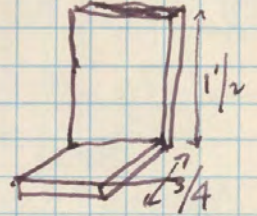
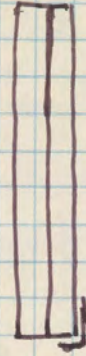
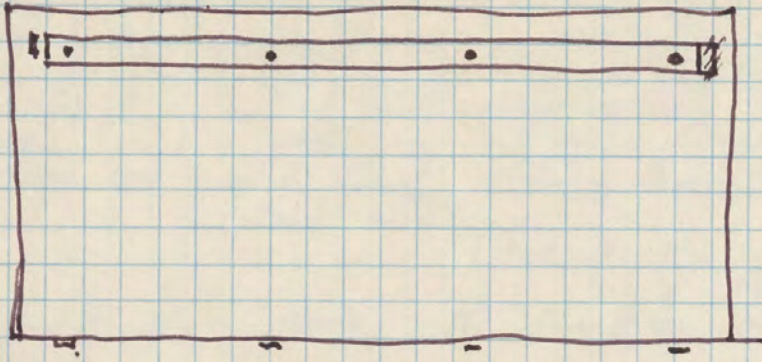

Tell Kabil. that Soma would be an ornamental structure (light)
over the Gugin, not dominant but with simple harmony.

1
2
3
4



is indicated by the
per symbol.

TELEGRAM

W. P. MARSHALL, PRESIDENT

1201

NL=Night Letter
LT=International
Letter Telegram

The filing time shown in the date line on domestic telegrams is STANDARD TIME at point of origin. Time of receipt is STANDARD TIME at point of destination.

BB419 B CDU815 WUD417

1959 OCT 20 PM 7

JNW360 78 PD INTL=CD WINDHOEK VOA RCA 20 1640=

=LT MR L K MARSHALL=

4 BRIANST CAMBRIDGE 38 BSN=

DUTCH REFORMED MISSION COMMISSION DECIDED TO START MISS
WORK IN THE OKAVANGO RESERVE AND BUSHMEN RESERVE STOP I
IT STILL POSSIBLE TO DONATE EQUIPMENT TO DUTCH REFORMED
CHURCH AS FORMERLY REQUESTED BUT NOW FOR BUSHMEN WELFARE
WORK URGENT AS DUTY ON EQUIPMENT TRANSPIRES WITHIN 8 DA
STOP CHURCH WILL SETTLE CUSTOMS DUTY STOP LETTER FOLLO
STOP THANK YOU IN ANTICIPATION=

REV STEFANUS VANDERSPUY SECR MISSION BOXMEIO WINDHOEK

==R 389.

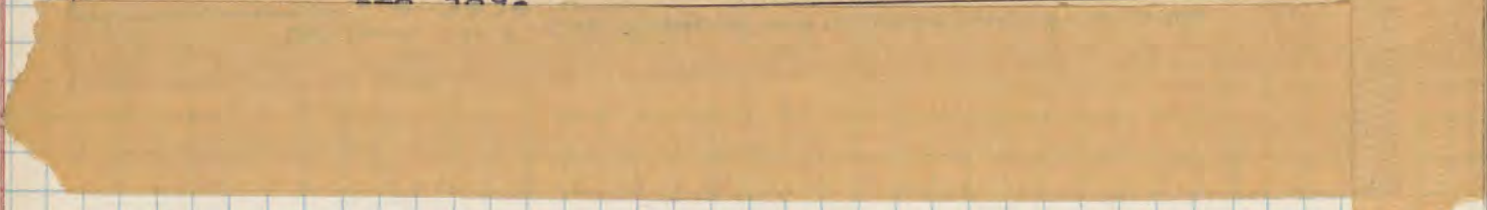

Claude M. Ingram
Bushman Affairs Commissioner
% Chief Native Affairs Commissioner
Windhoek SWA.

OCT 21 1959

Vanderspuy of Dutch Reformed Church cables request for trucks saying
urgent reply needed because duty transpires 28th which they can handle if
they can get trucks stop I cabled them you arranged two year postponed
duty and trucks loaned you indefinitely stop Is this still your understanding
and wish stop please investigate and cable me chargeable my account Johns
stops have no news shipment my good or disposal of Chevrolet could you
check would appreciate letter Marshall delivery Defort requested and
paid for to W.O.

Oct 21 1959

9

~~Vanderspuy~~ Reverend Stephanus Vanderspuy
Secretary mission Box ME 10 Windhoek SWAfrica
Before leaving ~~Windhoek~~ Southwester in August I loaned trucks
indefinitely to Bushman Affairs Commissioner M^cIntyre who
arranged with customs for two year extension duty requirements
stop. This arrangement confirmed by institutions here stop. I
have cabled M^cIntyre of your cable Marshall

10

Delivered to James Stevenson Oct 27 Monday

1. Gauguin Intimate Journals ✓
2. Lettres de P. Gauguin a E. Bernard ✓
3. Gauguin et son Temps ✓
4. Lettres de Gauguin a sa femme et ses amis ✓
5. Gauguin Kunstler ✓
6. Gauguin Cogniat ✓
7. Gauguin Pétouchamp ✓
8. Gauguin Alexandre ✓
9. Gauguin Menus ✓
10. Gauguin Marchuresnes ✓
11. Gauguin Malique ✓
12. Gauguin Druet
13. Gauguin Cat. J.F. 1936 ✓
14. " Wildenstein Exh. 1936 ✓

Gauguin -	Hamon
Courbet	Leger
Courbet	Cailleux 2 vols
Gauguin	Dorsenne
Courbet	Mac Osbau
Courbet	Courthion
Courbet	Hogama
Courbet	Maier Graeffe
Courbet	L'Atelier
Redon	Royer Marx

1963 sales of Sanders

Gain 13
150,000

^{cost}
Av/100 Sanders 576.72

Sales 277,547 Fed Cost 121.156

Fed Cost 14.67 ^{cost} highest, sold

Min Cost 77.27 200,000

E. BARTON CHAPIN, JR.

Fransiali - to April 10
70 Suffolk Rd,
Chestnut Hill 67
Mass.

Tel. palace 7-7321

CLASS OF SERVICE

This is a fast message unless its deferred character is indicated by the proper symbol.

WESTERN UNION

TELEGRAM

W. P. MARSHALL, PRESIDENT

SYMBOLS

DL=Day Letter

NL=Night Letter

LT=International Letter Telegram

1201

The filing time shown in the date line on domestic telegrams is STANDARD TIME at point of origin. Time of receipt is STANDARD TIME at point of destination

BA359 B CDV409 WUB412

19 04 27 PM 5 29

JNW225 121 PD INTL 1/50=CD WINDHOEK VIA RCA 27 1015=

LT MARSHALL=

4 BRYANTST CAMBRIDGE 38 BSN:

=MISSION UNDER IMPRESSION YOU WISHED TO DONATE TWO
SIXWHEELERS AND DODGE TO THEM STOP EXPLAINED THIS
NOT YOUR INTENTION OFFERED TEMPORARY USE ONLY STOP
MISSION DISSAPPOINTED AND NOW CONSIDERING OFFERING TO
PAY DUTY ON ALL TRUCKS IF YOU GIVE THEM DODGE OUTRIGHT
AND=

END 1#

CLASS OF SERVICE

This is a fast message unless its deferred character is indicated by the proper symbol.

WESTERN UNION

TELEGRAM

W. P. MARSHALL, PRESIDENT

SYMBOLS

DL=Day Letter

NL=Night Letter

LT=International Letter Telegram

1201

The filing time shown in the date line on domestic telegrams is STANDARD TIME at point of origin. Time of receipt is STANDARD TIME at point of destination

1927 OCT 27 PM 5 29

B CDV409 3/21=

GOODS SHIPPED BY ROBINHOOD ARRIVING BOSTON THIRD
 DECEMBER STOP GENERALMOTORS REPLACING CHEVROLET CHASSIS
 FREE OF CHARGE STOP LETTER FOLLOWS REGARDS=
 MCINTYRE==

4 38.

CLASS OF SERVICE

This is a fast message unless its deferred character is indicated by the proper symbol.

WESTERN UNION TELEGRAM

W. P. MARSHALL, PRESIDENT

SYMBOLS

DL = Day Letter

NL = Night Letter

LT = International Letter Telegram

1201

The filing time shown in the date line on domestic telegrams is STANDARD TIME at point of origin. Time of receipt is STANDARD TIME at point of destination

1959 OCT 27 PM 5 29

B CDV409 2/50=

TEMPORARY USE ONE SIXWHEELER FOR MISSION WORK BUSHMEN
IN OKAVANGO AND BANTUS IN KAOKOVELD STOP IF YOU WISH
TO ASSIST MISSION CONSIDER THIS BEST OFFER X CUSTOMS
BEING VERY DIFFICULT AND INSISTING ON PAYMENT OF DUTY
STOP WILL DISCUSS AGAIN WITH HEAD OF MISSION ON ABOUT
FOURTH NOVEMBER STOP YOUR=

END 2=====

HACKER ART BOOKS

57 WEST 54 STREET, NEW YORK 19



DATE 5/18/59
INVOICE S 7179
ORDER

SALESMAN

VIA Bookpost, ppd.

Mr. L. K. Marshall
4 Bryant Street
Cambridge 38, Mass.

La Renaissance du Sentiment Classique

\$10.00

ppd.

Richard Centie
 AF 11343065
 PO BOX 104

Lake Charles - AFS -

HE 30323 - Louisiana - ~~HE 69461~~
~~HE 30323~~ → 8455
 655

Of a Day is
 246

Wet Col.

~~General Offices~~ ~~HE 55320~~

